

# Dreamwood Series - Plan 6

2 Bedroom - 65m<sup>2</sup>

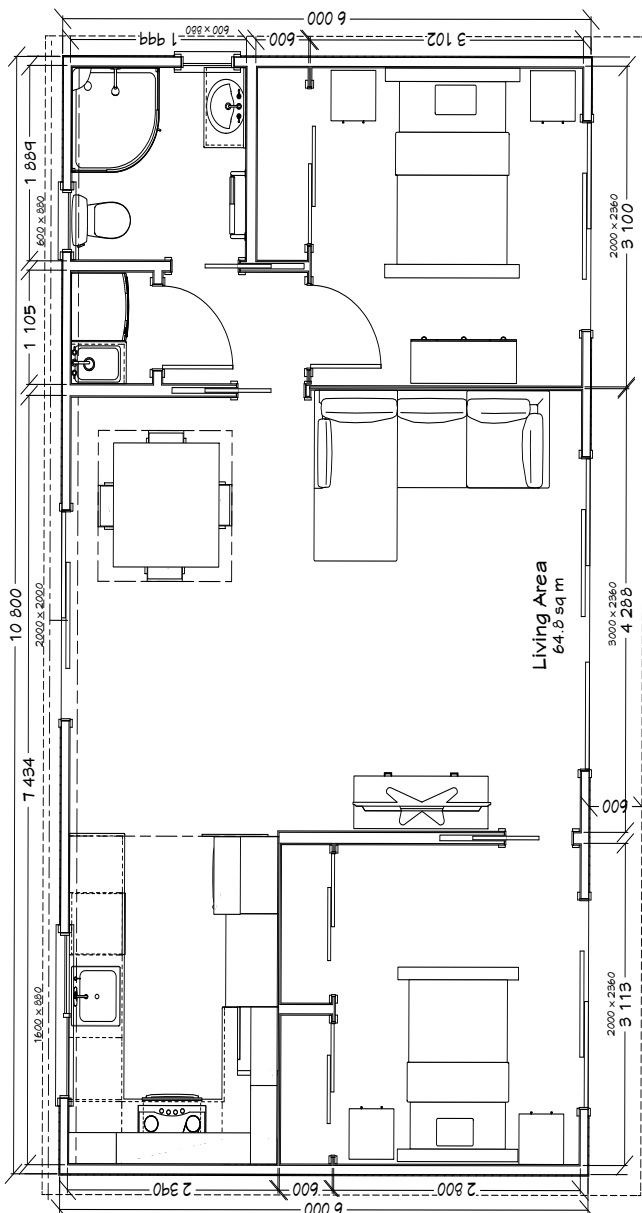

## Features:

- Durable solid wood interior
- Ply & batten cladding
- Open plan living
- Transportable design
- Raked ceiling throughout
- Double glazed windows & doors



1x Lounge



2x Bedrooms



1x Bathroom



1x Toilet



1x Laundry room



1x Dining

**TOUCHWOOD®**

*Naturally*

solid wood homes within your reach

[www.touchwoodsolidwoodhomes.co.nz](http://www.touchwoodsolidwoodhomes.co.nz)

