

 **dumawall**[®]
WATERPROOF WALL TILES



DumaWall +

Installation Guide

Installation Guide: DumaWall+

Decorative Wall Panels; virtually seamless joins without the cost.



General

- All the information is given and based on good building practice and are not a complete statement of all relevant data. As the installation of Dumwall is influenced by and relies on factors outside the control of PSP Limited, PSP Limited assumes no responsibility for the installation of Dumwall and their suitability to satisfy relevant Building Codes and Regulations,
- Our products are produced with the greatest possible care. However, no guarantee can be given with regards to small differences in look and colour in different production runs and batches. Therefore, installations in one room have to be carried out with products with the same production date. The date is stated on the label of the packaging box. Differences in look and colour once the product is installed with different production dates will not be accepted. Labels stating production dates will need to be provided.
- Wear protective gear during installation; safety goggles, mask, gloves, ear protection and steel cap boots.
- Always work in a well-ventilated area.

Note: Due to different production processes between the Dumawall XL and Dumawall + there could be slight colour differences if both products are installed in the same room.

For the Dumawall +PASS Scope & Limitations information please visit www.dumawall.co.nz or contact PSP Limited on **0800 786 883** or email info@psp.co.nz.

All wet wall substrates that Dumawall is to be adhered to must be waterproofed. For more information visit www.building.govt.nz – Code of practice for internal wet area membrane systems

Refer 8.1.4 Code of Practice – Dumawall + Tiles are installed by direct stick adhesive fixing to the waterproof membrane system or direct stick to a screen over a waterproof membrane system. The adhesive must be a solvent-less water-borne latex or acrylic adhesive. Dumawall + Tiles include planks or strips. The Dumawall + installation instructions must be followed. Dumawall – deemed vinyl.

Typical applications include:

- Private residences: bathroom, kitchen, laundry room, garage, basement, bedroom and living room.
- Professional applications: office space, sporting halls, shop areas, bathrooms, kitchen and laundry.
- Prefab houses: caravans, mobile homes and boats.

Health and Safety

Health and safety precautions must be taken when working with Dumawall products. Work areas must be well ventilated and kept clean. It is recommended that eye protection, dust mask, gloves and safety footwear are worn at all times. A dust mask must conform to AS/NZS 1715 and AS/NZS 1716 and eye protection conforming to AS/NZS 1337.1. Offcuts, shavings and dust must be disposed of in a manner that avoids the generation of dust and in accordance with the requirements of local waste authorities.

The panels may NOT be installed:

- Outdoors, on account of possible discolouration and the possibility that the product becomes brittle, unless explicitly stated or shown otherwise on the package insert.
- In spaces with a temperature in excess of 60°C or lower than -10°C, for example in a sauna or refrigerated area.
- On walls where the contact temperature may be above 60°C, e.g. on a chimney flue, by a stove or radiators,
- In poorly ventilated areas.

Pre-Installation

- Clean surfaces. Before starting, make sure all surfaces are clean, dry, smooth, and free from dust, grease, wax, etc. Clean the back surface of the panels by wiping with a clean cloth.
- Dry layout. It is recommended that you perform a "dry layout" prior to applying any adhesive. Measure walls, check for level and square. Depending on dimensions and room construction, you may need to trim some panels accordingly. Depending on your project, when fitting for dry layout, panels can be centered at a focal point, such as behind a sink or the center of a

Installation Guide: DumaWall+

Decorative Wall Panels; virtually seamless joins without the cost.



- room. For the purpose of the layout only, build out from both sides of the focal point, to ensure how the tiles fit into the space.
- Cut Dumawall Tiles using standard wood working tools like a table saw or circular saw with a fine-tooth blade to provide a clean, smooth cut (image C). Use a 60-tooth blade or higher. To ensure the base of the saw does not scratch the surface of the panel, we recommend protecting the surface with common painter's tape. Alternatively, you can score one side a few times with a utility knife and snap the tile at the line (image D, E). This method may require sanding the snapped edges.
- Cut panels for outlets and light switches. Measure and mark the borders where the opening will be with a marker. Drill a 12 mm to 25 mm hole using a drill in a corner of the cut-out section (image F). Use a jigsaw to cut the remaining opening, following your tracing (image G).
- If installing into a corner, the vertical flange must be cut off to allow for a plumb edge against the substrate (image H). The bottom flange should also be cut off of tiles when placing them on the ground. This will allow for a level edge on bottom (image I).
- Do not attach accessories like coat hooks, light fittings, mirrors, etc. directly to the tiles. Drill holes through the tiles and use suitable anchors to attach the accessories securely into the framing behind.

Maintaining a silicone joint

- Never wipe sealant with an UNGLOVED finger
- The tool used to finish the sealant surface must be free of saliva
- Mould can grow in wet or steamy areas if attention is not paid to adequate ventilation



Installation

- If you choose to finish the edges, we recommend our trim for both end pieces and inside corners. We recommend using baseboard or cove molding to finish the bottom row, regardless of flooring material. For both end trim pieces and corner trims, install trim in appropriate location prior to setting tile into trim (image J). If your project calls for DumaWall panels starting at a floor, be sure the first row is straight and level.
- To install your first panel, begin with bottom row and work from right to left due to the profile of interlocking tongue and grooves. Make sure the first panel you intend to install fits properly and is level. You may need to place a temporary shim under each bottom tile or use painter's tape to hold each tile in place while the adhesive sets (image L).
- Apply adhesive to the back of the panel. Carefully read and follow adhesive manufacturer's directions. Apply a 6 mm bead in a typical "M" or "W" pattern, and a bead around the tile perimeter about 6 mm (image M). The 10 oz. adhesive tube covers approximately 5 wall panels.
- Installation in environments exposed to a direct flow of water (bathroom shower) require a 3 mm bead of clear silicone sealer be placed inside both grooves on every tile (image A). Add a bead of silicone along recently cut edges (see instructions below) to be placed into the corner. Repeat this process on perpendicular tile also facing corner (image B). Check sealer manufacturers guidelines. Sealant and Adhesive: Adhesive - DumaFix, Sika Ms123, Sealant - Sikasilc NG, Gorilla Kitchen & Bathroom, Gorilla MS Sealant.
- Apply the panel to the substrate by pressing it into place. Apply even pressure with your hands across the entire panel. If necessary use painter's tape, pins, to hold panels in place until the adhesive sets.
- Wipe off excess adhesive. Use water and a cloth. Clean off any adhesive residue that is visible while it is still wet. Do not allow this residue to dry as it will be difficult to clean up when dry and could damage the finish.
- Connect the next tile by fully inserting the tongue into the groove (image N).

Installation Guide: DumaWall+

Decorative Wall Panels; virtually seamless joins without the cost.



- Repeat until bottom row is complete. If installing in a corner, cut off the flange facing the corner to allow a plumb surface against the substrate. Repeat this process on tile that abuts the previous one also facing the corner. Between the bottom edge of the dumawall + and the shower tray a silicon joint must be applied.
- Allow the adhesive on the bottom row to set up. See adhesive manufacturer's directions. The time necessary can vary from 20 minutes to several hours.
- Determine what tile pattern you want to use before starting the second row (image O, P). Commonly-used options are running bond (vertical joints are staggered) and stack bond (vertical joints line up).
- After the first row has set up, apply the remaining tiles according to the pattern or layout you desire. Use adhesive and methods described above for remaining rows.
- When installing the top row, install as you have been until you get to the last tile in the corner. If ties butt against your ceiling, when installing the last tile remove flanges from the bottom and side (image Q). Lay tile into place. Apply pressure to ensure tile is flush with others Use a recommended silicone sealer-as previously described-in joints to ensure a water-tight installation if applicable.

Shower Trays

Overlap the top edge of the shower tray, while maintaining a approximate 5 mm between the edge of the shower tray and the Dumawall+. Apply a bead of silicon to the upper edge of the tray lip or flange before the Dumawall+ is installed.

Bath or Basin Edge

For an aesthetic appearance a Starter Trim (Aluminum Anodised), can to be fixed to the bottom edge of the panel. Prior to positioning the edge of the panel into the Starter Trim, silicone shall be applied into the jointer channel so the channel is at least 1/3 full. When the panel is located into the channel it is likely that silicone will be forced out of the Starter Trim channel up the front and back of the panel.

This action should eliminate water tracking down into the channel. Make sure the silicone is cleaned off the face of the panel before curing

Generally most new baths or basins come complete with a raised lip or flange on the top edge. Overlap the lip or flange, while maintaining an open gap of approximately 5 mm. Apply a bead of silicon to the upper edge of the lip or flange before the sheet is installed. If your bath does not have either a raised lip or flange, a proprietary flashing is the simplest solution to waterproof these junctions. Ensure the flashing has sufficient cover over the fixture edge.

Bath wall installation options

There are numerous baths available from many different manufacturers. Refer to bath manufacturer's installation guidelines and typical details.

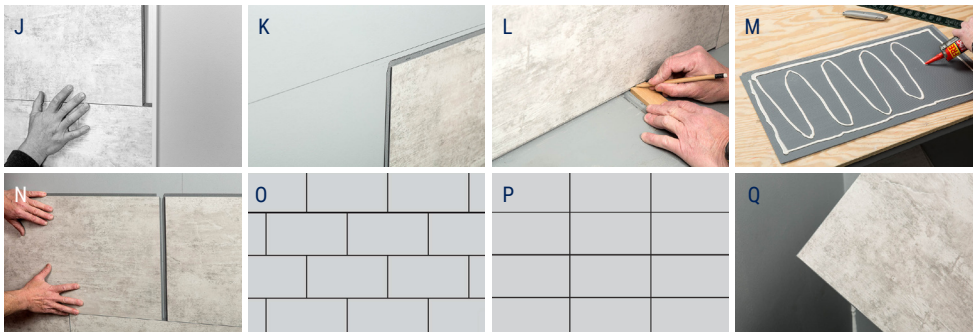

Installation Guide: DumaWall+

Decorative Wall Panels; virtually seamless joins without the cost.



Cleaning

Dumawall panels can be cleaned and polished to their original condition by using any typical household, non-abrasive cleaning agent. Normally, you only need a damp cloth to clean the panels thoroughly. Do not use abrasive, aggressive substances or cleaning products based on chloride. We do not recommend using solvents. Adhesive residue or pen marks are best removed using isopropyl alcohol. Please test a non-conspicuous area first before a full clean of the surface.

DumaWall Trim and Last Piece in Row Installation

If you are using corner and/or L-trims for a Dumawall shower kit installation, this guide will show how to install the last, short tile at the end of a row. Read and follow this guide if your project looks like this:



Short tile piece needed to finish row on an inside corner

The challenge is to place the remaining tile section into the edge trim while also getting the interlocking tile edges locked together.

First, install the inside corner trims into each corner using adhesive. Allow 24 hours for the adhesive to cure. Make sure the corner trims are oriented as in the image below. Each inside corner trim piece has a full and a partial channel. The full channel will be against the back wall.

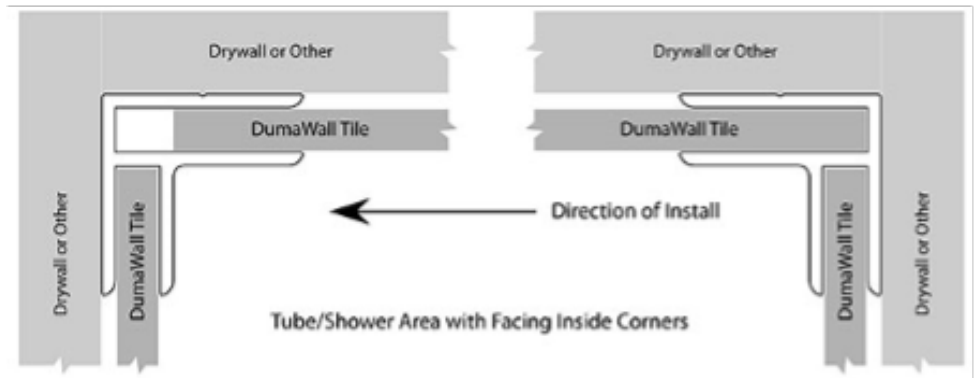

Installation Guide: DumaWall+

Decorative Wall Panels; virtually seamless joins without the cost.



1. Next, determine the length of the tile section. Measure from the inside lip of the previously installed tile to the inside edge of the pre-installed trim. See image at left for details. In this case, the length to cut the final tile in the row is 101.6 mm (as shown).



2. After cutting tile to length, apply adhesive to the substrate, as shown. Spray a squirt or two of water onto the substrate and adhesive, as shown. This will lubricate the substrate allowing for easier movement.



3. Insert the cut tile edge into the L-trim while holding the interlocking joint-edge away from its mating tile.



4. Insert cut end into edge trim channel while holding other edge up. Push the tile into the edge trim while laying the tile down toward the substrate. When pushed into the trim entirely, the interlocking edges will be exposed.



5. Apply sealant to the interlocking edges if this installation is for a wet environment. For further details refer to the Dumawall Installation and follow the sealer manufacturers guidelines. The tile can now be manually pulled into place. Pull the tile toward the interlocking joint. If necessary, rubber gloves can be used to increase grip friction with the surface of the tile. See image below. Keep pulling until the interlocking joint is tight. Pull tile into interlocking joints.



6. Interlocking joints at tile's right and bottom are tight. Use a damp rag or paper towel to clean off any sealant or adhesive that may have been squeezed onto the tile surface.

Installation Guide: DumaWall+

Decorative Wall Panels; virtually seamless joins without the cost.



Universal Corner Trims

Universal Corner Trims should be attached with adhesive to the substrate. Dispense a small bead of adhesive directly to the substrate corner or on the trim itself. Also dispense a bead of sealant into each of the trim's channels to prevent water from reaching the substrate.

DumaWall - Universal Corner Trim

For 5.0mm Thick Panel - Cross Section

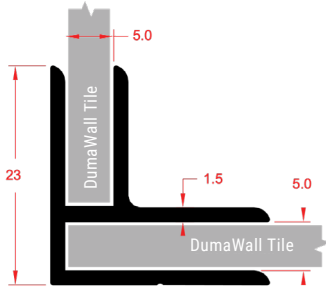

Universal Corner Application

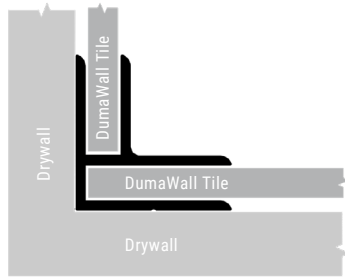

Finishing Trims are used to finish the terminal end of tiles when not adjoined to anything. To install, don't dispense adhesive a few millimetres from the tile's edge where you intend to use the Finishing Trim. This will allow the trim to slide into place. Dispense a bead of sealant into the receiving channel of the trim and then press the trim into place.

DumaWall - Finishing Trim

For 5.0mm Thick Panel - Cross Section

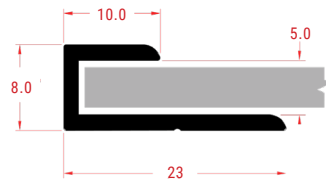

Finishing Trim Application

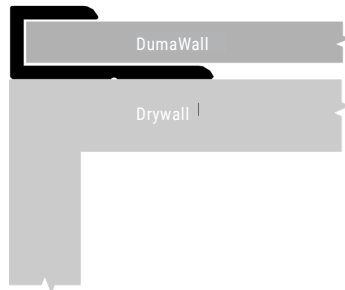

Installation Guide: DumaWall+

Decorative Wall Panels; virtually seamless joins without the cost.



L-Trims are used to cover existing exposed tiles to provide a finished look (see drawing below). Install by dispensing a thin bead of sealant on the DumaWall side and a thin bead of adhesive on the substrate side. Press trim into place. If trim will not stay in place, use some masking or painter's tape to hold until adhesive sets.

DumaWall - L-Trim

For 4.2mm - or 5.0mm Thick Panel - Cross Section

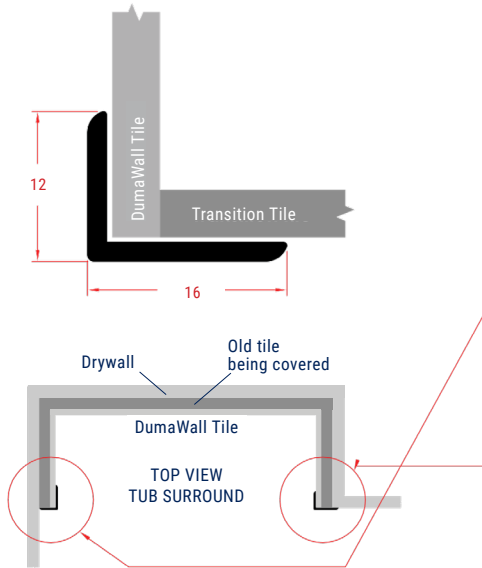

L-Trim Applications

