

- NOTES:
1. PROVIDE NEW DOOR SEALS TO EXISTING EXTERNAL DOORS. REFER DOOR SCHEDULE
 2. PROVIDE ELECTRIC UNDERFLOOR HEATING (EUH), REFER HEATING & COOLING SCHEDULE
 3. PROTECT EXISTING TIMBER FLOOR BOARDS & CARPET TO BE RETAINED DURING CONSTRUCTION
 4. COVER EXISTING FLOOR GRILLES WHERE NEW FLOOR FINISH IS BEING INSTALLED

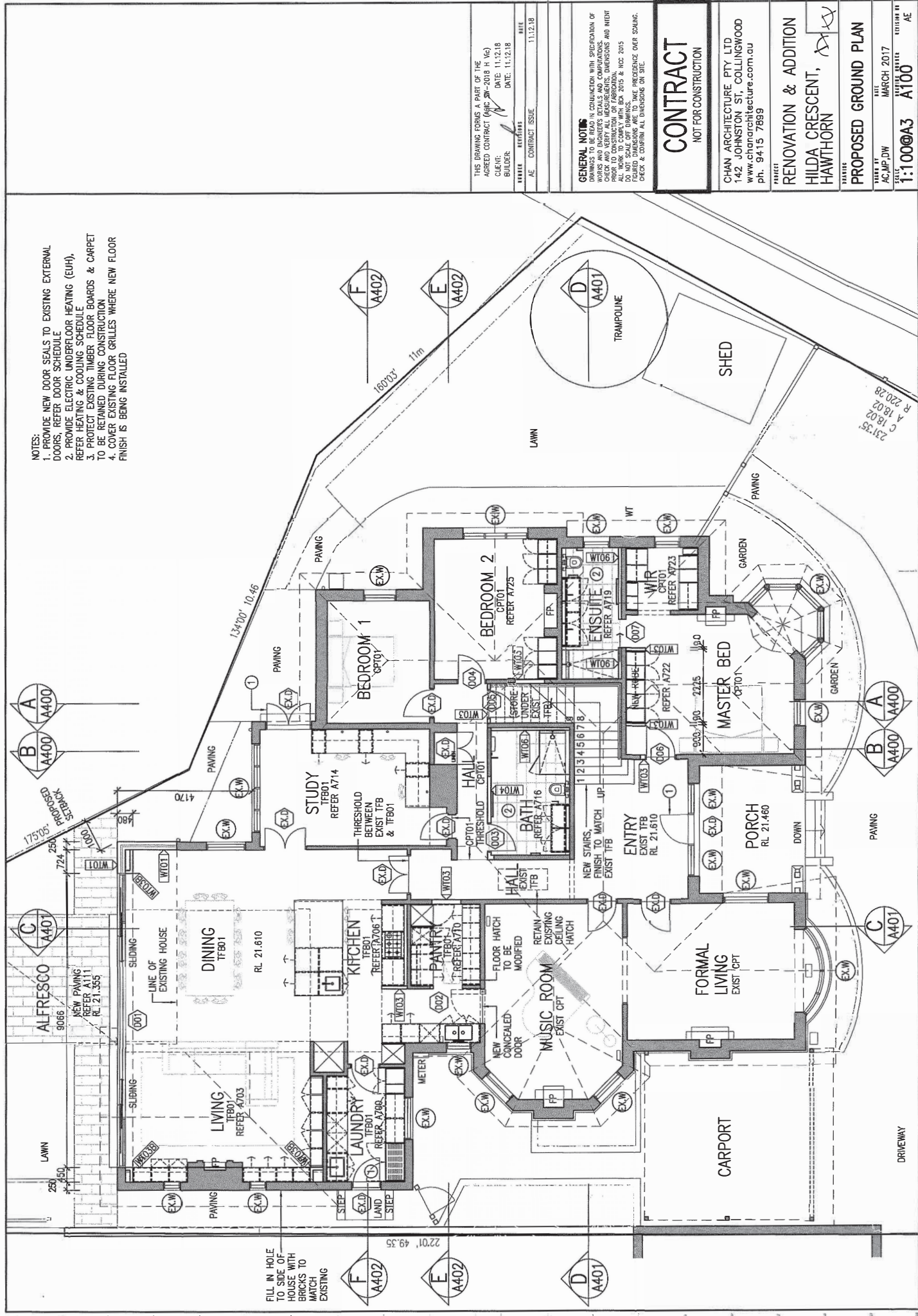

THIS DRAWING FORMS A PART OF THE AGREED CONTRACT (MHC 2016-2018 H Va.)
 CLIENT: [REDACTED] DATE: 11.12.18
 BUILDER: [REDACTED]
 TITLE: RENOVATION & ADDITION
 SHEET: 11.12.18

GENERAL NOTES
 DRAWINGS TO BE READ IN CONJUNCTION WITH SPECIFICATION OF WORKS AND ENGINEER'S DETAILS AND COMPUTATIONS FOR STRUCTURE AND SERVICES. ALL DIMENSIONS AND HEIGHTS TO BE CHECKED PRIOR TO CONSTRUCTION OR FABRICATION. ALL WORK TO COMPLY WITH BCA 2015 & NZC 2015. DIMENSIONS ARE TO TAKE PRECEDENCE OVER SCALING. CHECK & CORRECT ALL DIMENSIONS ON SITE.

CONTRACT
 NOT FOR CONSTRUCTION

CHAN ARCHITECTURE PTY LTD
 142 JOHNSTON ST, COLLINGWOOD
 www.chanarchitecture.com.au
 ph. 9415 7889

PROJECT
 RENOVATION & ADDITION
 HILDA CRESCENT,
 HAWTHORN

PROPOSED GROUND PLAN
 DATE: MARCH 2017
 DRAWN BY: AC/JP/DW
 SCALE: 1:100@A3
 SHEET NO: 11

231'35"
 C 18'02"
 R 220'28"

FILL IN HOLE TO SIDE OF HOUSE WITH BRICKS TO MATCH EXISTING

NOTES:
 1. PROVIDE ELECTRIC UNDERFLOOR HEATING (EUH), REFER HEATING & COOLING SCHEDULE TO TITLE BACKSHEET

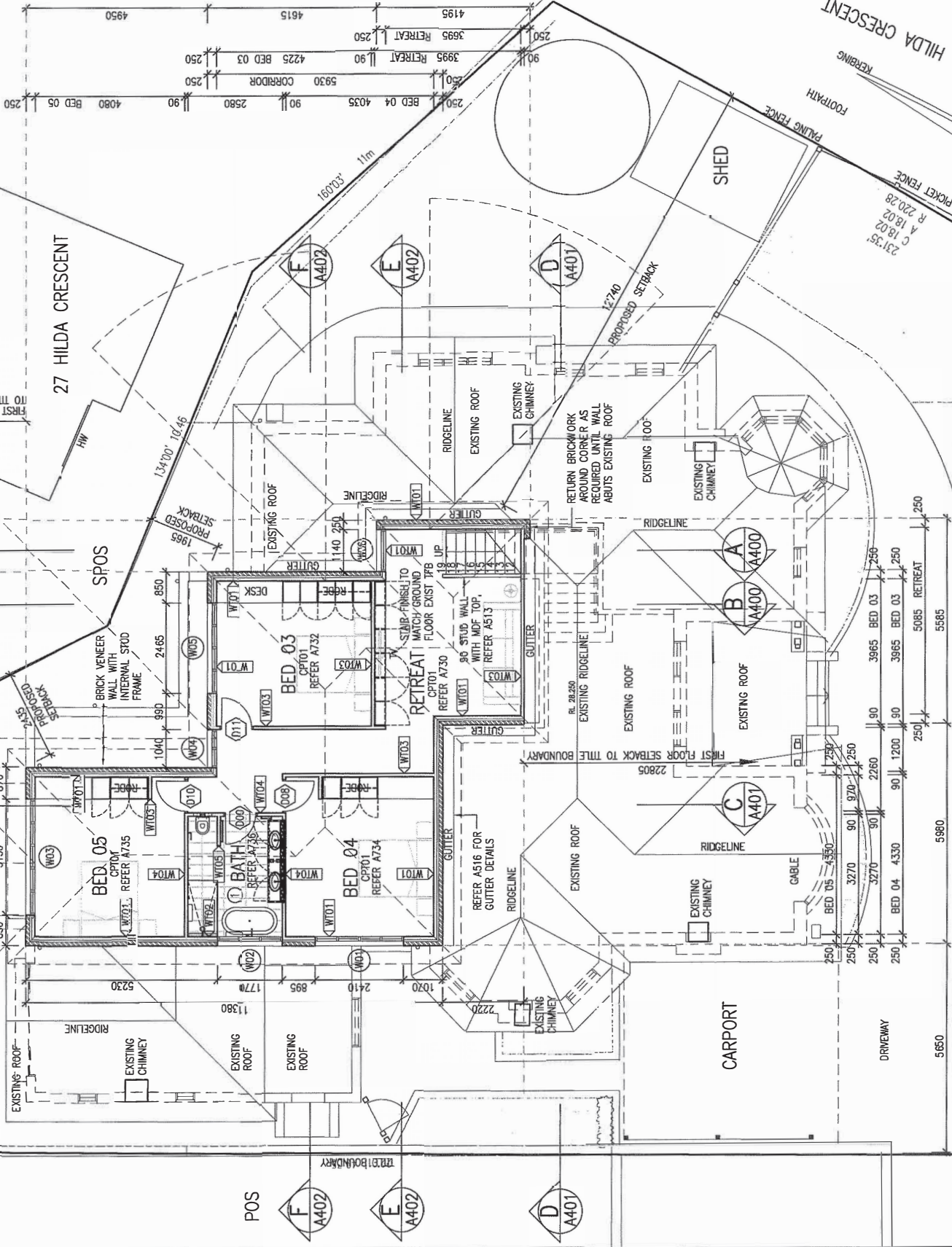

THIS DRAWING FORMS A PART OF THE AGREED CONTRACT (ASC SW-2018 H V6)
 CLIENT: DATE: 11.12.18
 BUILDER: DATE: 11.12.18

DATE: 11.12.18
 CONTRACT ISSUE

GENERAL NOTES
 DRAWINGS TO BE READ IN CONJUNCTION WITH SPECIFICATION OF WORKS AND ENGINEER'S DETAILS AND COMPANIONS. ALL WORK TO COMPLY WITH BCA 2015 & NZC 2015. DIMENSIONS ARE TO TAKE PRECEDENCE OVER SCALING. CHECK & CONFIRM ALL DIMENSIONS ON SITE.

CONTRACT
 NOT FOR CONSTRUCTION

CHAN ARCHITECTURE PTY LTD
 142 JOHNSTON ST COLLINGWOOD
 www.chanarchitecture.com.au
 PH: 9415 7889

PROJECT: RENOVATION & ADDITION
 HILDA CRESCENT, HAWTHORN

DATE: MARCH 2017
 DRAWN BY: AC/MP/DW
 CHECKED BY: A101

SCALE: 1:100@A3