

ŌAMARU STONE

new zealand limestone



Ōamaru stone is pure, organic limestone. It offers all the unique beauty that nature has to behold.

Research tells us that interacting with nature is good for us. We intuitively know this. Nature makes us happy.



Parkside Quarries Ltd
151 Airedale Road
5.D.R.D.
Ōamaru 9492
Phone: 03 433 1134
Email: sales@oamarustone.co.nz
www.oamarustone.co.nz

CONTENTS

Central Otago Project	p4
Wanaka Project	p6
Masterton Project	p8
Waitaki Project	p10
South Canterbury Project	p12
Waikato Project	p14
Yu Mei Project	p16
Riverstone Castle	p18
Farmers Corner	p20
History	p22
Quarrying operation	p22
Why Ōamaru Stone?	p23
Contact information	p24

Ōamaru Stone Shines in Central Otago



Designed and built in 2012, this iconic design has become a classic, often copied floor plan.

The site of this Pisa Moorings house in Cromwell, Central Otago is the ideal location for the qualities of Ōamaru Natural Stone to radiate.

The owners brief to the architect focused on natural stone and pitched roofs. To enhance the industrial style of the house, the lines are bold and consistent all the way around.

Large fibre cement boards were used to complement Ōamaru Natural Stone. The boards were cut so that each section was exactly the same size as two Ōamaru Natural Stone blocks, to ensure that the mortar lines married up. Another unique decision was to leave relief in the mortar lines, to further accentuate the lines around the walls.

Owners, Stephen and Helen Kidd say:

"Parkside Quarries was very good to deal with. We were shown around the quarry where we picked stone with not too much colour. That was what we wanted. The quarry put the stone aside for us until we were ready to build. We did experience some significant delays due to events and situations not related to the quarry, but the quarry was flexible and we had a clear communication channel between ourselves, the quarry and the block layer, which meant that we were happy with the end result. One of our favourite features is the curved saw marks on the walls which pick up the sunlight during the day."



Product: **Sawn faced stone**

Size: **650 x 90 x 290**

Custom cut for window/door
jambs, lintels and sills

Colour Palette: **Ivory**

Location: **Cromwell**

Architect: **Stevensons, Dunedin**

Photographer: **Graham Warman**

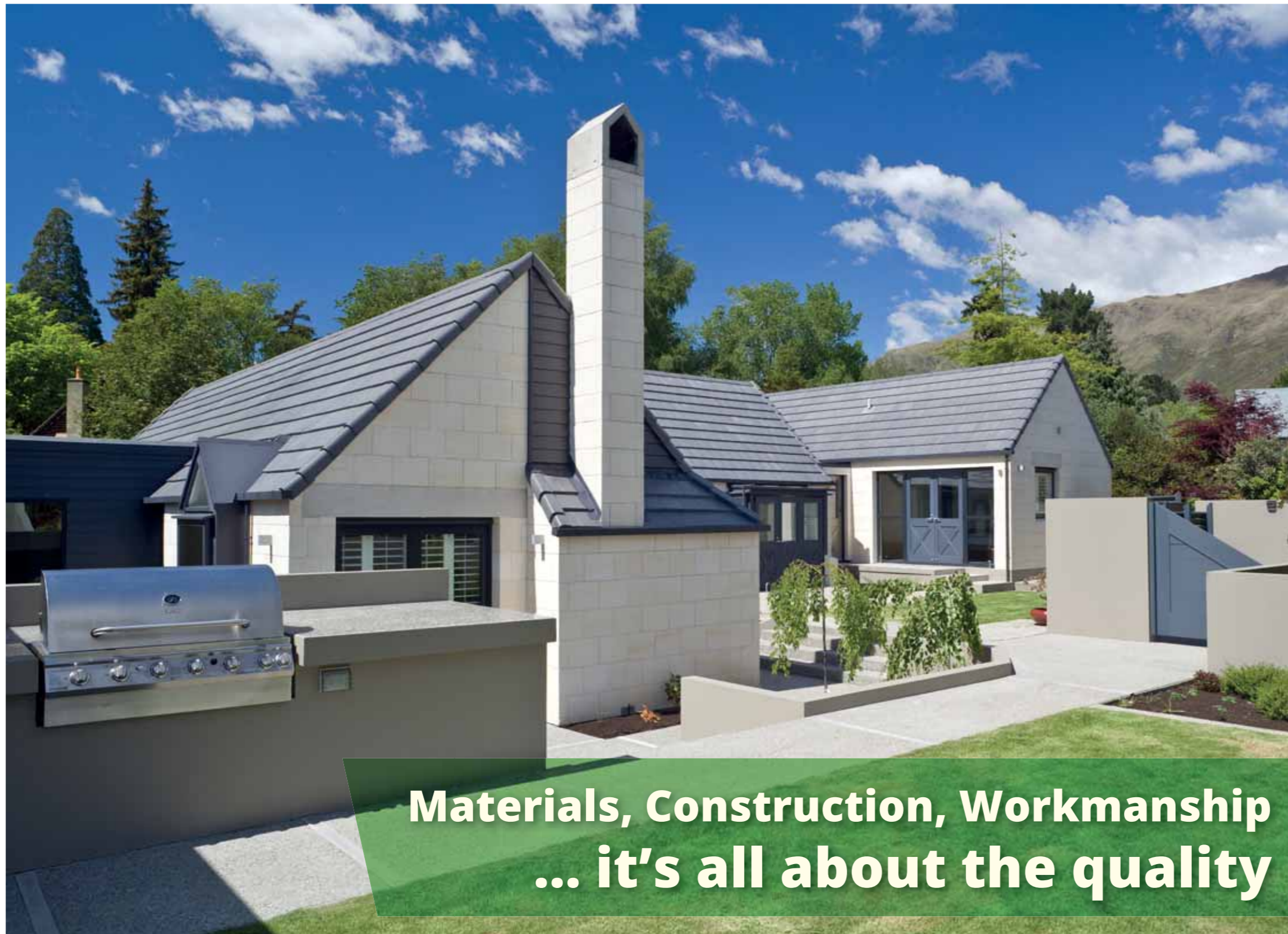

Materials, Construction, Workmanship ... it's all about the quality

Despite having great character, an existing 1970's Ōamaru Stone home was insular and had no visual or physical connection of the fantastic lake views directly over the adjoining lakeside reserve.

The clients considered pulling the house down but as the house was well constructed with good materials and workmanship, it was decided to develop upon the character of the existing house and to add new living areas & a master bedroom suite connecting to the uninterrupted lake & mountain views while allowing vistas through the building into private courtyards and landscaping.

From this mix of old and new, a number of themes were developed upon; Open / Enclosed; Day / Night; Summer / Winter; Formal / Informal.

Individual external spaces were created with each of the internal spaces having its own outdoor court allowing users to follow the sun, avoid the wind or to seek some privacy.

Ōamaru stone acts as the common link between new and old sections of the house, as well as new landscape elements.

Ōamaru stone is also brought into the house, connecting the external cladding into the entry and link spaces and cladding both the interior and exterior of the chimneys.

Different techniques such as sawn faces and random widths were all utilised to celebrate the properties of this unifying material.

Architect Chris says:

"Ōamaru stone is a beautiful and an entirely local product, highly suited to this area. I would like to see more of it".

Owners John & Lesley say:

"The property has featured in Magazines such as Trends and visitors are often surprised that the original part of the property was built in the 1970's".



Product: **Split face, sawn face stone**

Size: **Various sizes**

Colour pallet: **ivory**

Architect: **Chaney Norman**

Location: **Wanaka**

Builder: **Iain Whyte Building**

Photographer: **Jamie Cobeldick**



**WINNER - Residential Home 2019
Category
NZ Institute of Architects
in the Wellington architecture awards.**

In May 2019, Wellington-based architect Andrew Sexton won two house awards presented by the NZ Institute of Architects in their 2019 Wellington architecture awards.

One was for his parent's house in the

Cashmere Oaks subdivision on the northern edge of Masterton.

Ōamaru stone is the feature in all of the central spaces of this home, from the entranceway, to the central courtyard, to the fireplace.

The Cashmere Oaks house has stunning views of the Tararua Ranges – something the design makes full use of. "Every room we use has a view," John says.

Judges comments:

"The detailing of the stone around the fireplace, and in other areas, illustrates the high level of care and attention expended on the project."

Owners, John and Heather Sexton say:

"We love living everyday with natural Ōamaru limestone!"



Product: **Sawn faced stone**
Size: **650 x 90 x 390**
Colour Pallet: **Ivory**
Location: **Masterton**
Architect: **Andrew Sexton
Architecture**



The Borrie's home is located in Papakaio, 21 km's from Ōamaru. It is carefully positioned on a rise overlooking the farm and out towards the Southern Alps.

The single level rectangular forms have a façade that combines Ōamaru stone and red cedar panels, with additional elements of both the natural stone and timber in the form of columns and beams.

Each of the spaces is of various size, depending on function and use. One common aspect throughout is that in every room, Ōamaru stone is visible from a window or door.

Owner, Adrienne Borrie says:

"We have always loved Ōamaru Stone. Our brief to John Donnelley who designed our home was that we wanted Ōamaru Natural Stone everywhere. We would have had it inside as well as outside, but John suggested that if we positioned windows in specific places, we could look out from the comfort of being inside and see the Ōamaru Stone lining the outside walls. So, we have columns and windows in places for the sole purpose of being able to gaze at the Ōamaru Stone. The one piece of stone we have inside is an Ōamaru Stone side table, which we had commissioned to fit into the entrance way. We never get sick of looking at the stone".

Product: **Sawn faced stone**

Size: **650 x 90 x 390**

Colour pallet: **Ivory**

Location: **North Otago**

Designed by: **John Donnelly**

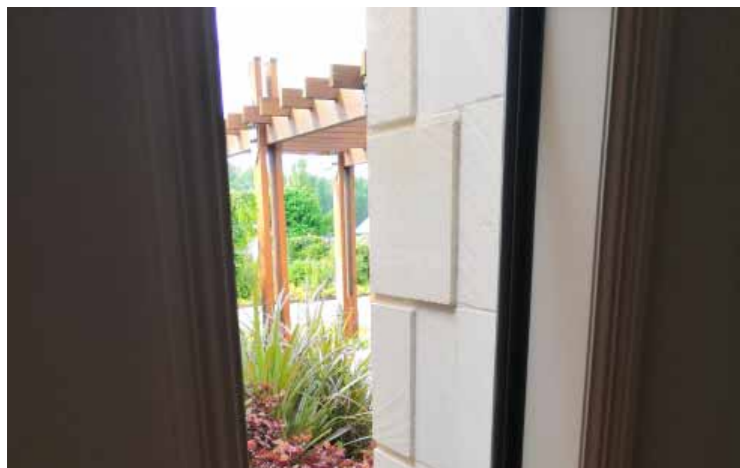



This beautiful family homestead is entirely clad in various formats of Ōamaru stone. Split and bolstered stone with quoin details on the corners give a nod to the past on this totally modern home. Traditional stonemasonry techniques have been used to achieve a sense of permanence.

Product: **Split and Bolstered Ōamaru Lime stone**

Product #2 **Sawn Faced Ōamaru stone for corners and window/door surrounds.**

Size: **Random lengths x 90 x 190mm high & 90mm**

Colour Palette: **Ivory**



Owners, Marie and Cam

weighed up a couple of natural stone options to work alongside the natural cedar. Part of the process to decide between the different stones was to visit the Ōamaru natural stone homes on Riverside Road and Newstead Road in Hamilton. Once the owner saw the creamy colour and ran their hands across the Ōamaru natural stone, the couple knew they wanted it.

They chose Red Architecture to build their new home because they really liked the style of previous residences Tane had designed.

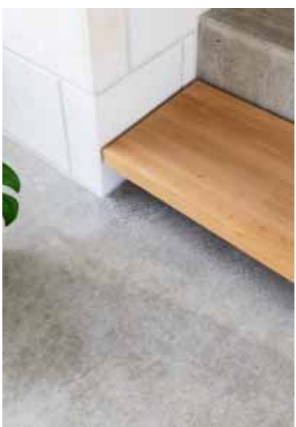

Product: **Sawn Faced
Ōamaru Limestone**

Size: **650 x 90 x 390**

Colour palette: **Ivory**

Architect: **Tane from Red Architects**

Photo: **Larnie Nicholson**



Understated Luxury

Local Iconic brand Yu Mei displays beautiful nappa leather accessories with back drops of Ōamaru natural limestone.

Located on the characterful Kent street in Newmarket, the newest Yu Mei store pays homage to its former life as a foundry with exposed brick and natural materials like onyx marble, and limestone from Parkside Quarries in Ōamaru.

The deer nappa used to make the brand's products is farmed in Ōamaru, so the geographical link between the brands is strong.

The aesthetic link is also strong. Yu Mei are a top New Zealand Leather brand and are (*direct quote from their website*) devoted to the creation of understated luxury. Although natural limestone has a rustic finish, it is a stunning statement of luxury.

Yu Mei's mission is to create quality products that will weather your journey with you. Ōamaru stone is a product that will be steadfast through many generations.

Knight Associates designed custom shelving units with Ōamaru stone back panels with a sandblasted finish, a new concept for the quarry. The thin panels give a neutral tone backdrop to the beautiful Yu Mei handbags. Ōamaru stone plinths, using the same sandblasting technique were also fabricated to provide visual interest and additional display space.



Product - **Sandblasted Ōamaru Stone panels**

Size - **960mm x 50mm x 450**

Colour pallet - **Ivory veining**

Interior Designer - **Nathan Varga, Knight Associates**

Shopfitter - **Fit out Solutions**

Photography - **Jono Parker**



Dot's home and Castle, with solid masonry walls clad in large bolstered Ōamaru stone blocks give the building an air of permanence.

Ms Scott (Architect) says everything will "definitely stand the test of time".

"A standard building, to comply with the building code, has to last 50 years. Smithy [Neil Smith] said, 'I don't want 50 years. I want 200'."

A total of 20,000 concrete blocks and approximately 200 tonnes of Ōamaru stone were used in the castle's construction with the exterior walls almost half a metre thick.

Internal beams were crafted from century-old macrocarpa milled on one of the Smiths' farms.



Product: **Split & Bolstered Ōamaru stone with sawn corner stones and window/door surrounds.**

Size: **600 x 90 x 400**

Colour **Palette: Ivory**

Quantity: **200 Tonnes!**

Architect: **Sarah Scott from Condon Scott**

Location: **Pukeuri, North of Ōamaru**

Stone mason: **Ian Gold**

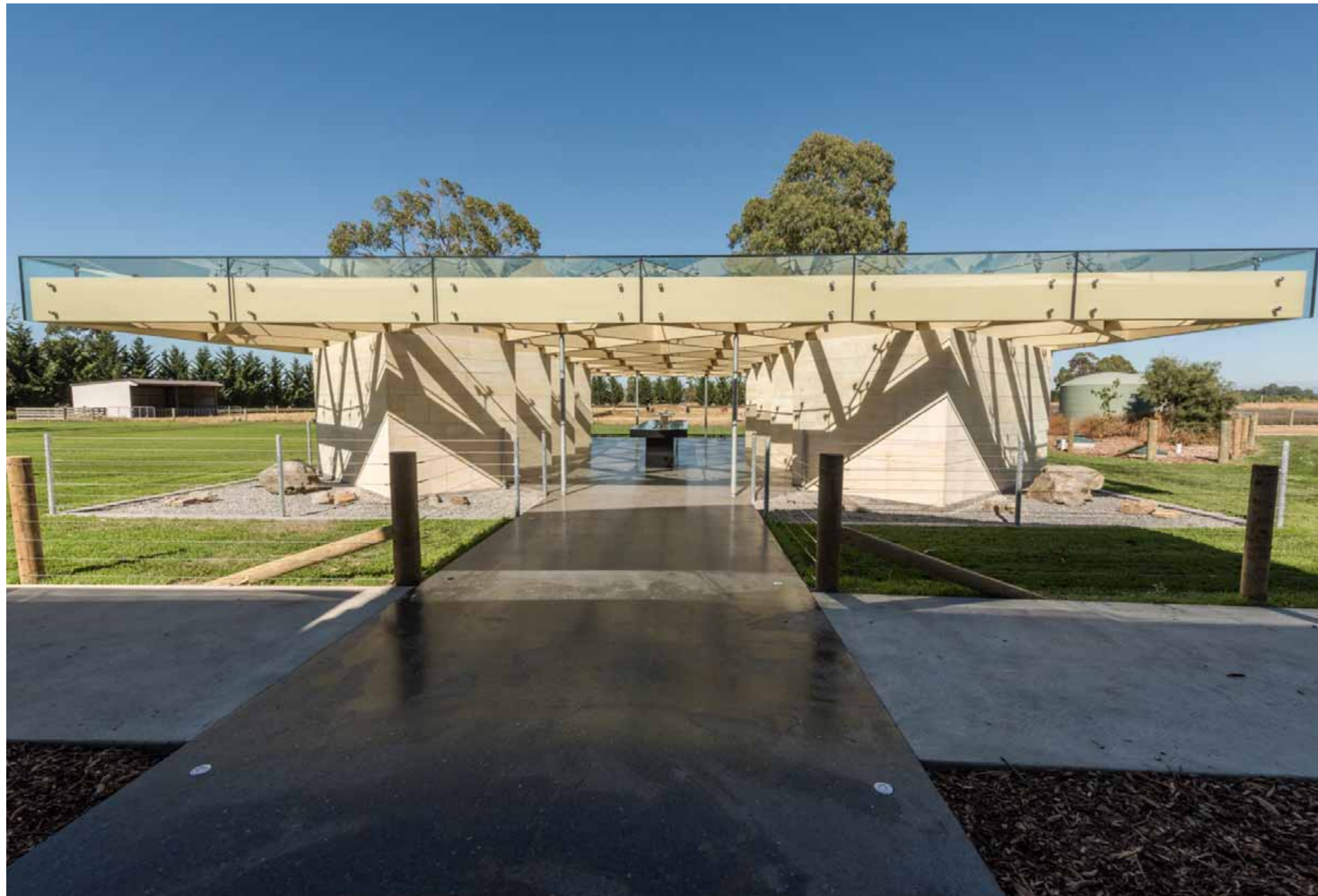

New Zealand Commercial Project Award Winner – Under \$2million category

The client's brief was quite simple – they wanted the best public toilet facility in the Southern Hemisphere. With no predetermined budget, the options to deliver this vision were endless.

The project team used ground breaking timber engineering to form a fully exposed structural frame, which supported a sloping glass roof.

The exposed highly polished concrete floor slab was designed and installed to minimise cracking from the extensive services that were laid within.

The walls were clad both internally and externally with Ōamaru Stone.

Judges said that “...together these provide an iconic envelope to enclose the high-quality fixtures and fittings, including the large hand-crafted communal wash trough”.

And

“...the result is a facility where a visit to the toilet has become a photo opportunity exceeding expectation. This project definitely delivered upon the client's brief”.

In this instance the requirement was for various lengths and heights, all at a width of 30mm. The stone mason applied the slips adhering them directly to the concrete block foundation. The flush mortar joints give the effect of a solid wall, while the geometric steel roofing detail adds a dynamic element, bringing light and shadow into play all across the building.

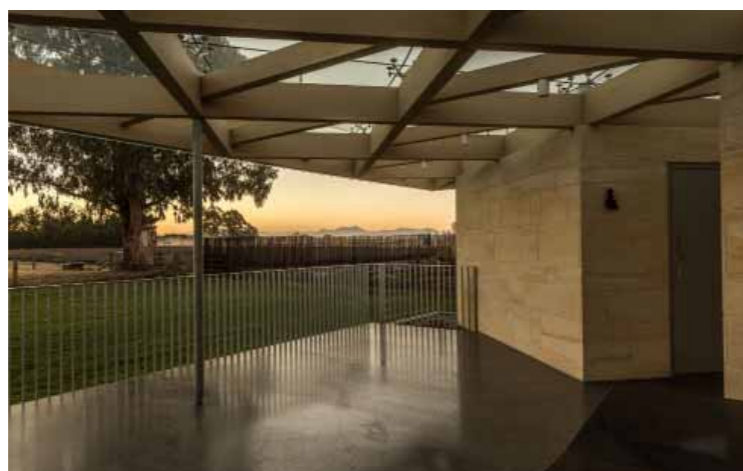

Product – **Sawn faced Ōamaru Stone slips**

Size – **Various heights and lengths, 30mm thick**

Colour pallet – **Autumnal hues**

Associate product – **Laticrete waterproofing membrane and adhesive system**

Construction Company: **Quaid Construction Ltd**

Stone Mason: **Murry Wagstaff**

Location: **Ashburton**

History

As early as the 1860's limestone has been quarried at various sites around North Otago to build some of New Zealand's most prominent architecturally designed buildings. In 1906 the first stone was quarried from the current site on the Parkside farm. Some of the first stone produced from Parkside was used to build Ōamaru's iconic Opera House (pictured above). These days all the other quarries are gone but Parkside remains quarrying this high grade creamy limestone that has enhanced exteriors and interiors with an impressive range of styles for over 100 years.



Quarrying operation

Originally a large steam driven chainsaw mounted on rails was used to cut the stone from the quarry floor. This saw was later converted to diesel and more recently was power driven. This method has now made way for 3 metre circular blades with tungsten tips. These saws operate hydraulically on Parkside's excavators.

Once cutting is complete the large 2 tonne slabs of Ōamaru Stone are broken out of the quarry floor, loaded onto trucks and carted to the factory approximately 400 metres away. These blocks are then individually loaded onto trolleys which are used to feed the three breakdown circular saws. The 1.80 metre tungsten tipped saws cut the stone to the required size before the stone is stacked and strapped onto pallets ready for transport to site.

Why Ōamaru Stone?

Unique:

All the natural imperfections you would want to constantly delight.

Versatility:

Various face finishes are available, from the rustic split face to a more sophisticated honed face finish. Size-wise, Ōamaru stone blocks can be dimension cut to standard size or customised for your project.

Our CNC machine can cut and carve, engrave and shape with effortless efficiency.

Natural:

Entirely organic, Ōamaru stone is pure limestone, the most pure substance you could possibly build with.

Complementary:

Nothing can compare to the rich texture and warm creamy colour of Ōamaru Stone. Its natural look means it blends perfectly with other materials such as timber, schist, iron and brick.

Endurance:

When erected to correct specifications, Ōamaru Stone has a proven record of endurance. Many prominent limestone buildings around New Zealand, some built well over one hundred years ago have stood the test of time. Properly treated Ōamaru Stone will maintain its natural look and beauty for future generations to enjoy.





Ōamaru stone is a prestige natural limestone, NZ grown, NZ owned and without the price tag.

Buy direct from the quarry.

For pricing or technical information contact Parkside or visit our website.

www.oamarustone.co.nz



Parkside Quarries Ltd

151 Airedale Road

5.D.R.D.

Ōamaru 9492

Phone: 03 433 1134

Email: sales@oamarustone.co.nz