

Twentyone

Four incredible
homes. One
unmatched location.

Welcome to Twentyone, a marriage of architectural design and new generation thinking, situated right in the heart of Te Atatu Peninsula. With a passion for great style and a life lived well, we set out to make homes for those who value creativity, conscious living and the freedom to live how you like.



Artist's impression



*Creative,
contemporary living in
the heart of a vibrant
community*





Developed by designers, these stand-alone freehold properties prioritise liveability, with light-filled, soulful spaces featuring superb design details at every turn. From courtyard entertaining, to relaxed family living to a busy home office, these stunning homes allow you to create your own perfect balance of work, rest and play. This is a rare opportunity to own a beautiful and affordable architecturally designed home in one of Auckland's most sought-after suburbs.



Artist's impression



Artist's impression

Floor plans

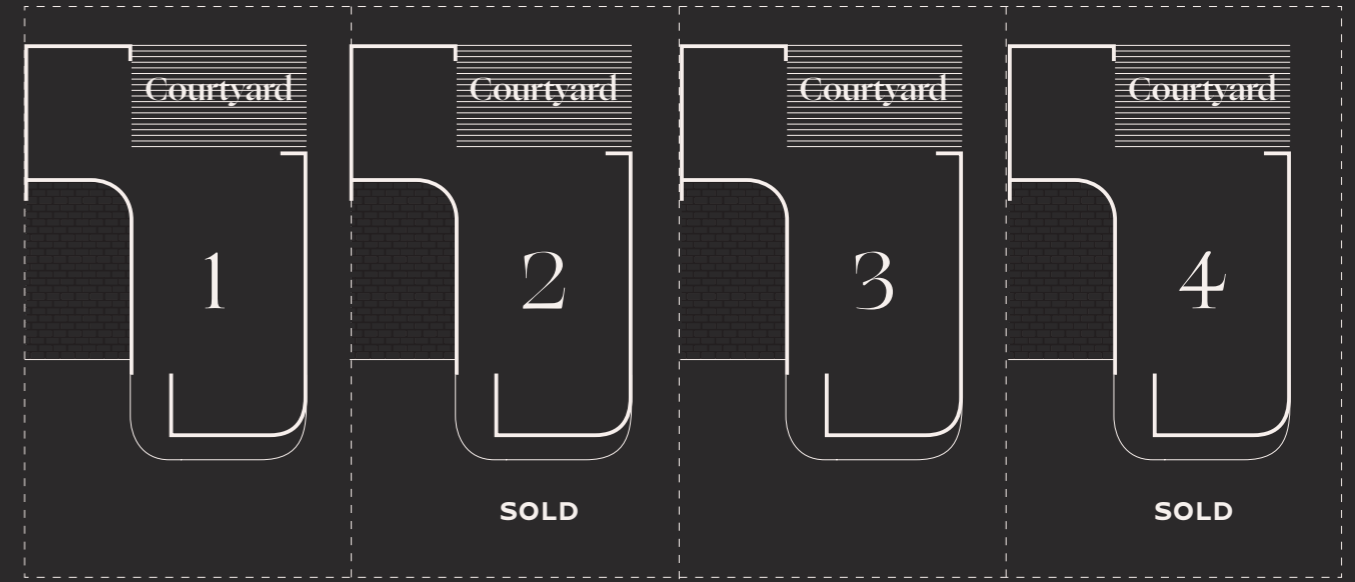

Ground Floor

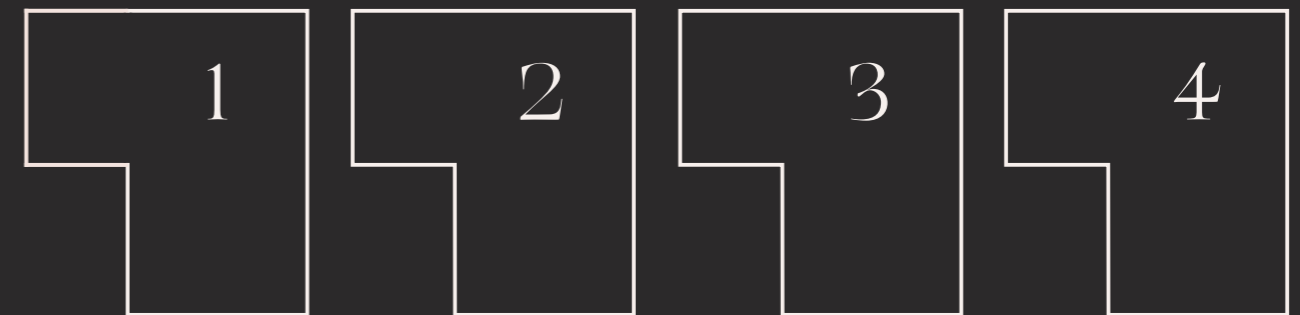

First Floor

Unit 1

143m²
Dwelling: 105m²
Bedrooms: 3
Courtyard: 24m²

Unit 2

143m²
Dwelling: 105m²
Bedrooms: 3
Courtyard: 24m²

SOLD

Unit 3

143m²
Dwelling: 105m²
Bedrooms: 3
Courtyard: 24m²

Unit 4

155m²
Dwelling: 105m²
Bedrooms: 3
Courtyard: 26m²

SOLD

All Lots



Ground Level

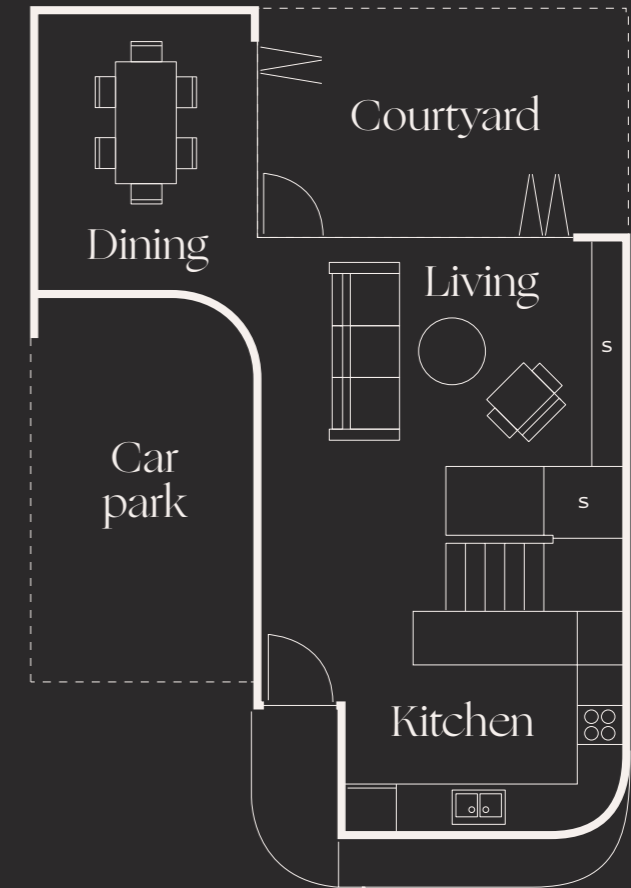

Level 1





Design details

Materials and fittings may be subject to change upon availability

Kitchen



Joinery
Melteca Puregrain finish / Aged Walnut



Joinery
Melteca naturale finish Bayleaf

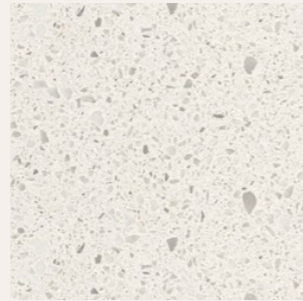

Benchtop
Caesarstone / Nougat



Feature Tiles
41zero42 Ceramic Biscuit Peak / Green



Wall tiles (splashback)
Yubi Cloud Mosaic / MT1676 / Gloss/ Midas

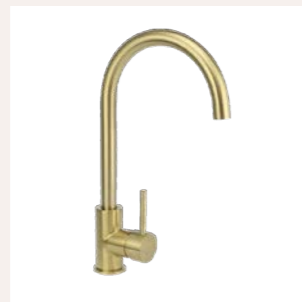

Tapware
Elysian Kitchen Mixer Bronze or White / ABI Interiors



Dishwasher
Fisher & Paykel 60cm freestanding dishwasher



Cooktop
Fisher & Paykel 60cm 3 zone induction cooktop



Rangehood
Fisher & Paykel Integrated rangehood



Oven
Fisher & Paykel single 85L 7function oven / white



Carpet
Cavalier Bremworth Levante / Shamal / Flooring Xtra

Bedroom

Flooring & Wall Textures

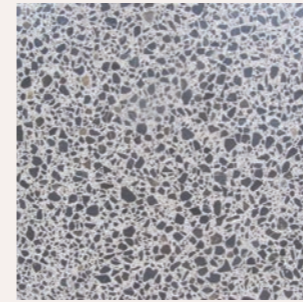

Flooring
Peter Fell C2 Polished Concrete Floor 189



Feature wall finish
Strand board / Laminex White washed

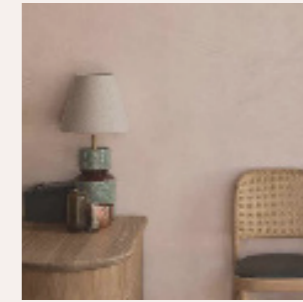

Feature wall finish
Soft plaster wall / Beach Break interiors

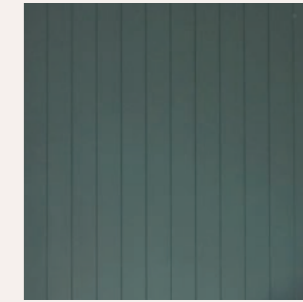

Feature wall finish
HardieGroove / Lining

Bathroom

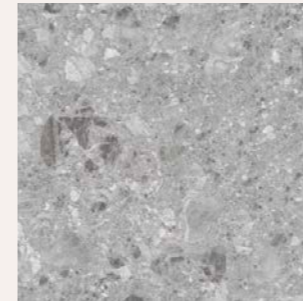

Main tiles (floor & wall)
Affogato / mid grey / Tile Space

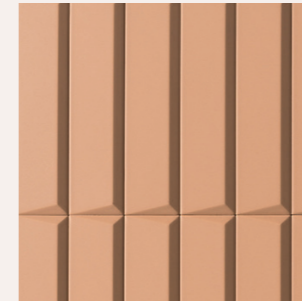

Feature tiles
41zero42 Ceramic Biscuit Peak - Terracotta

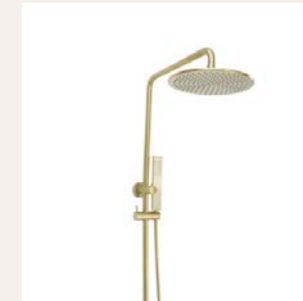

Showerhead
Finley Shower Rail / Brushed Brass / ABI Interiors



Heated Towel Rail
Otto Heated Towel Rail / Brushed Brass / ABI Interiors



Mirror
Haynes Glass Polished Edge / Ellipse/Round

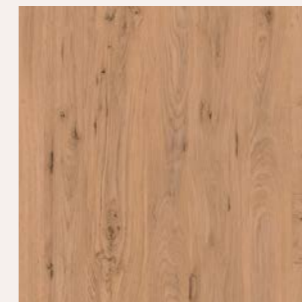

Joinery
Melamine French Oak

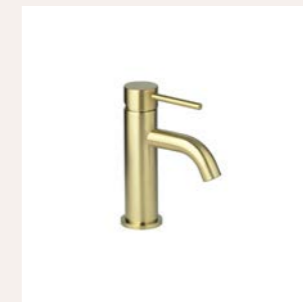

Tapware
Elysian Minimal Mixer + Spout, Brushed Copper / ABI interiors

External

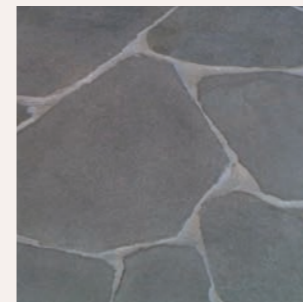

Paving
Crazy Paving Bluestone

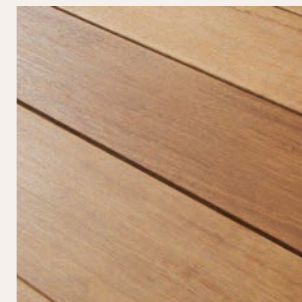

Decking
140mm Vitex Hardwood Decking on H3.2 timber joists

Footsteps from the
coast, minutes from
the city



This sun-drenched, bustling community is swiftly becoming one of Auckland's fastest growing suburbs—and for good reason. Just 15 minutes from the city and surrounded by water on three sides, you'll find picturesque coastal walks a stone's throw from your front door, along with great cafés, craft beer, local boutiques, an organic grocer and waste-free supermarket all within walking distance.

Weekends on Te Atatu Peninsula are a joy, with the flat landscape making it ideal for a morning out on the bike or by foot, exploring the many parks and coastline paths, through the Peninsula's wetland reserve with incredible views across to the city and harbour bridge. There's always something on in this tight-knit community, from the regular food truck night markets to yoga and Pilates classes at the bustling community centre. With great schools, plenty of sports amenities and a fast-growing foodie scene, it's little wonder this suburb is popular with families and creatives alike.

Map



Brought to you by
the expert team at
I Am Developer.

Passionate about creating beautiful, liveable homes for everyone, I Am Developer's team of designers, investors, developers, creatives and property enthusiasts have contributed to nearly 100 homes over the past two years. They've set out to help empower more people to build positive, meaningful projects, and help a new generation of kiwis into homes.



Thomas & Jess, Directors,
I Am Developer

Development Partners:
Profico

Profico are property investors with a portfolio of residential and commercial property and land holdings in the Christchurch and Auckland regions. Lead by Canterbury local Grigori Koulanov, his carefully selected team are passionate about the vision to build warm and aesthetically pleasing homes.

Builder:
Next Level Commercial

Geotech:
Bwn Limited

Planning:
Blueprint Planning

Structural Engineers:
Constructure

Surveyors:
Tripp Andrews

Civil Engineers:
Tripp Andrews

Secure your home
today

I Am Developer

DISCLAIMER – Every Precaution has been taken to establish the accuracy of the material herein at the time of printing, however, no responsibility will be taken for any errors/omissions. Prospective purchasers should not confine themselves solely to the content of this material and acknowledge that they have received recommendation and had reasonable opportunity to seek independent legal, financial, accounting, immigration, technical and other advice. The material herein was prepared solely for marketing purposes prior to the commencement of construction and the approval of necessary Territorial Authority consents. The final building design and materials are subject to Auckland Council approval. The Developer reserves the right to change the sizes and layouts of residences throughout the development. Changes may be made during development and all dimensions, finishes, fittings and specifications are subject to change without notice. All residences sale areas include ducts, gardens, decks or fences as applicable and where shown. Sizes stated are measured in accordance with the clauses contained within the Sale and Purchase Agreement. All illustrations are artist's impressions only. Loose furniture, feature and pendant lighting, window dressings and wall coverings are shown for illustration purposes only and are excluded from the Purchase Price. All illustrations and artist's impressions of the landscaping to private courtyards, gardens and decking are indicative only and excluded Purchase Price.